

**User manual
Mobile phone
Maxcom MM835**



Reading this Manual prior to using the phone is highly recommended.

The set includes

Mobile phone

USB cable

Battery

Quick start guide

Warranty card

Keeping the package is recommended as it might be used for transport.

Keep the receipt as it required for warranty.

Important – The phone works in the following networks:

GSM: 850/900/1800/1900 MHz;

WCDMA: 900/2100 MHz;

LTE band: 1/3/7/8/20.

Prior to switching on the phone, a SIM card must be correctly installed.

Contents:

1	Introduction	6
2	Accessories	6
3	Safety precautions	6
4	Emergency call (112)	7
5	Basic information	8
6	Phone preparation	10
6.1	Removing the battery cover	10
6.2	SIM card installation	10
6.2.1	<i>SIM1 i SIM2</i>	10
6.3	Memory card installation	11
6.4	Battery installation	12
6.5	Connecting the AC adapter and charging battery	12
6.5.1	<i>Low battery warning</i>	13
6.6	Switching on and off the phone	13
7	Display description	14
7.1	MENU operation	14
7.2	Entering text	15
8	Phone book	15
8.1	Saving contacts	15
8.2	Browse contacts	15
8.3	Deleting contacts	15
8.3.1	<i>Deleting a single contact</i>	15
8.3.2	<i>Deleting several contacts</i>	16
8.3.3	<i>Deleting all contacts</i>	16
8.4	Copying contacts	16
8.5	Speed Dial	16
8.6	Memory status	16
8.7	Favourite contacts	17
9	Calls	17
9.1	Dialing calls	17
9.1.1	<i>From the numeric keypad</i>	17
9.1.2	<i>From the phone book</i>	17
9.1.3	<i>From the call log</i>	17
9.1.4	<i>From the favourite contacts</i>	17
9.2	Adjust the call volume	18
9.3	Options during a call	18
9.4	Incoming calls	18
10	Call logs	18
11	SMS and MMS messages	19
11.1	Writing and sending SMS and MMS	19

11.2	Reading and replying to SMS and MMS	20
11.3	SMS boxes	21
11.3.1	<i>Inbox</i>	21
11.3.2	<i>Outbox</i>	22
11.3.3	<i>Drafts</i>	22
11.3.4	<i>Sentbox</i>	22
11.4	Deleting messages	22
11.5	Message settings	22
11.5.1	<i>SMS</i>	22
11.5.2	<i>MMS</i>	23
11.6	Voicemail	23
12	Multimedia	23
12.1	Images	23
12.2	DV	23
12.3	Audio	23
12.4	Video	24
12.5	Recorder	24
13	Camera	24
14	FM radio	24
15	Tools	24
15.1	Calendar	24
15.2	Calculator	25
15.3	Alarm	25
15.4	Internet	25
15.5	World clock	26
15.6	Bluetooth	26
15.7	Torch	26
15.8	File manager	26
15.9	STK (SIM services)	26
16	Settings	26
16.1	Phone settings	26
16.1.1	<i>Time & date</i>	26
16.1.2	<i>Language settings</i>	26
16.1.3	<i>Shortcut settings</i>	27
16.1.4	<i>Auto power on/off</i>	27
16.1.5	<i>Power management</i>	27
16.1.6	<i>Restore factory settings</i>	27
16.2	Call settings	27
16.2.1	<i>Dual-SIM</i>	27
16.2.2	<i>Answer mode</i>	27
16.2.3	<i>Call divert</i>	28

16.2.4	<i>Call waiting</i>	28
16.2.5	<i>Call barred</i>	28
16.2.6	<i>Caller ID</i>	28
16.2.7	<i>Others</i>	29
16.3	<i>Display</i>	29
16.4	<i>Theme</i>	29
16.5	<i>Profiles</i>	29
16.6	<i>Dial Num Voice</i>	30
16.7	<i>Side key +/-</i>	30
16.8	<i>Menu selection</i>	30
16.9	<i>Security</i>	30
16.9.1	<i>PIN</i>	30
16.9.2	<i>Modify PIN2</i>	30
16.9.3	<i>Phone locked</i>	30
16.9.4	<i>Modify the cellphone password</i>	30
16.9.5	<i>Privacy</i>	30
16.9.6	<i>Fixed dialing number</i>	31
16.9.7	<i>Blacklist</i>	31
16.10	<i>Connections</i>	31
16.11	<i>Check update</i>	31
17	<i>SOS</i>	31
17.1.1	<i>ICE contacts</i>	32
17.1.2	<i>Owner info</i>	32
17.1.3	<i>SOS button</i>	32
17.1.4	<i>SOS SMS</i>	32
17.1.5	<i>Emergency alarm</i>	32
18	<i>Connection to a computer</i>	33
19	<i>FAQ (Troubleshooting)</i>	33
20	<i>Technical Specifications</i>	35
20.1	<i>Main functions:</i>	35
20.2	<i>Operating Frequency Range and Max Conducted Power</i>	36
20.3	<i>SAR information</i>	37
21	<i>Battery Information</i>	38
22	<i>Protect your environment</i>	38
23	<i>SIMPLIFIED EU DECLARATION OF CONFORMITY</i>	39
24	<i>UK DECLARATION OF CONFORMITY</i>	39

1 INTRODUCTION

Thank you for choosing the Maxcom telephone.

This User Manual has been published by the Manufacturer. Corrections and amendments arising from errors and inaccuracies in current data and from the phone or software improvements might be made without prior notifications; they will be, however, included in updates versions of user manuals. To learn more go to: www.maxcom.pl/en. The Manufacturer reserves their rights to any and all content of this Manual.

Copyrights and trademarks mentioned in this document remain the property of their owners. Copying, transferring, storing, or dissemination of the materials, in whole or in part, covered by the copyrights, without a prior written consent of their authors, is prohibited.

2 ACCESSORIES

Use only batteries, chargers, and accessories recommended by the Manufacturer of this phone. Check their availability in your point of sale.

3 SAFETY PRECAUTIONS

Reading the guidelines below will minimize the risk of misusing the phone.

USING – The telephone emits electromagnetic field that might negatively interfere with order electronic devices including medical equipment.

Never use the phone in any area where the use of mobile phones is prohibited such as hospitals, refueling points, or in proximity to flammable materials. Using phones in such places might expose others to danger.

Never use the phone while driving.

A device and its accessories might contain small parts. Keep the phone and all parts out of reach of children.

SERVIS – Any repairs or modifications of the phone on your own are not allowed. Any issues should be taken care of by qualified service only.

CLEANING – Never clean the phone with any chemicals or corrosives.

HEARING AID – If the User has a hearing aid, adjust the phone volume and the hearing device sensitiveness carefully.

ELECTRONIC MEDICAL EQUIPMENT – The telephone is a radio transmitter that might negatively interfere with electronic medical devices such as hearing aids, heart pacemakers, and insulin pumps, etc. A distance between the phone and the implanted device should be at least 15 cm. To learn more, contact your health care provider or manufacturers of such equipment.

WATERPROOF – The phone is not waterproof. Keep it dry at all times.

DUSTPROOF – The phone is not dustproof. Never use the phone in a place with increased concentration of dust. Protect the phone against metal chips that might cause the phone to malfunction.

DISPLAY SCREEN – Excessive pressing on the LCD screen and using sharp tools should be avoided as it might cause the screen to be damaged.

Never press the battery contacts with metal objects as doing so might cause an explosion.

Never expose the phone to either low or high temperature, direct sunlight, and high humidity. Never place the phone next to heating devices such as radiators, heaters, ovens, furnaces, camp fires, barbeque, etc. The maximum allowable ambient temperature is +40 °C.

Protect your hearing! Prolonged exposure to loud sounds might damage your hearing. Listen to music at a moderate level, and do not keep the phone too close to an ear, while using a speakerphone. Lower the volume prior to using headphones.



4 EMERGENCY CALL (112)

To call the emergency number (112), you should:

Switch on the phone in a place with sufficient reception.



Enter the emergency number 112 and confirm the call with the green headset key.

Important! While making a phone call, you are required to give all information to the emergency response officer. Never hang up prior to answering all relevant questions!

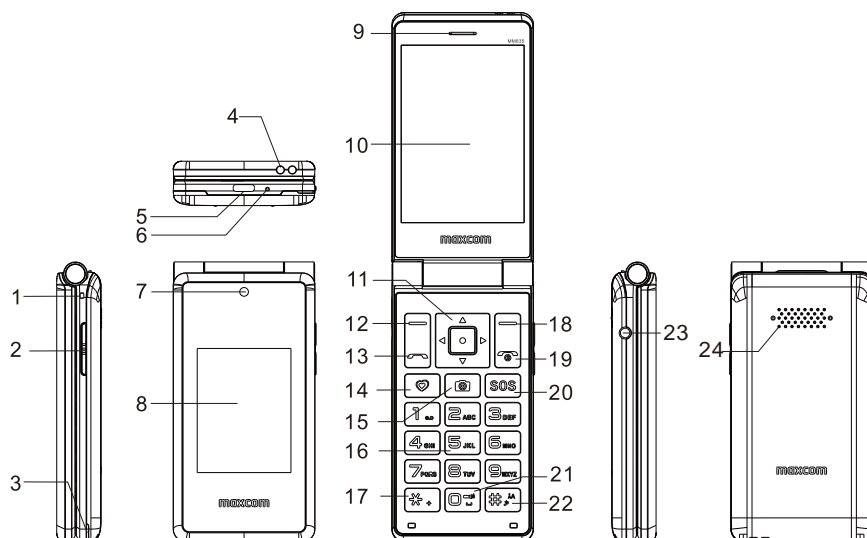
5 BASIC INFORMATION



1	Lanyard holder	It allows to mount a lanyard
2	+ / - key	Volume up / down. Mute ringtone during an incoming call.
3	Opening the battery cover	
4	Torch	LED diode emitting white light
5	Female USB-C socket	It allows to charge the phone's battery and connect it to a computer via a USB-C cable
6	Microphone	
7	Camera	It allows to take photos / record videos
8	External display	
9	Call speaker	Active during conversations
10	Display	Displays ongoing processes on the phone in real time
11	Navigation keys up / down / left / right	To move up / down / left / right through the displayed content on the display
	OK key	In standby: OK – main Menu. In Menu: press OK to select the highlighted item.

		Camera – take a photo, start / pause video recording.
12	Left function key	Performs the tasks described in the lower left corner of the display
13	Green handset	Answering incoming calls / call logs
14	 key	Press: enter to favourite contacts
15	 key	Press: turn on camera
16	Numeric keypad	Allows you to enter numbers / characters Key 1 – press and hold to call your voicemail. Key 2 ÷ 9 – press and hold to call previously programmed speed dial number.
17	 key	Pressing while editing text allows you to access special characters
18	Right function key	Performs the tasks described in the lower right corner of the display
19	Red handset	Press: reject / hang up calls,exit to desktop. Press and hold: turn the phone on / off.
20	SOS key	Press and hold: triggers the SOS procedure
21	0 key	Press and hold to turn the flashlight on / off
22	# key	Pressing while editing text allows you to change the input keyboard. Press and hold to quickly change the profile i.e. normal / silent / meeting
23	Female Jack 3.5 mm socket	It allows to connect a headset
24	Speaker	Active for multimedia / ringtones

6 PHONE PREPARATION

6.1 Removing the battery cover

Make sure the power supply is unplugged. In the lower right corner of the phone, gently pry the battery cover with your fingernail and remove it.

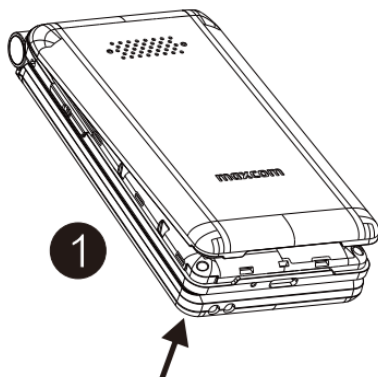

6.2 SIM card installation

Insert at least one SIM card into your phone before you start using it. You will receive a SIM card from your operator. Keep the SIM card out of the reach of children.

Any scratch or bend might easily damage the SIM card, therefore be extremely careful while inserting, removing and storing the SIM card.

6.2.1 SIM1 i SIM2

SIM1 and SIM2 slots are designed to install Nano SIM cards (4FF).

Insert the SIM card into the slot with the gold-plated connectors facing down and the beveled corner facing outside the phone.

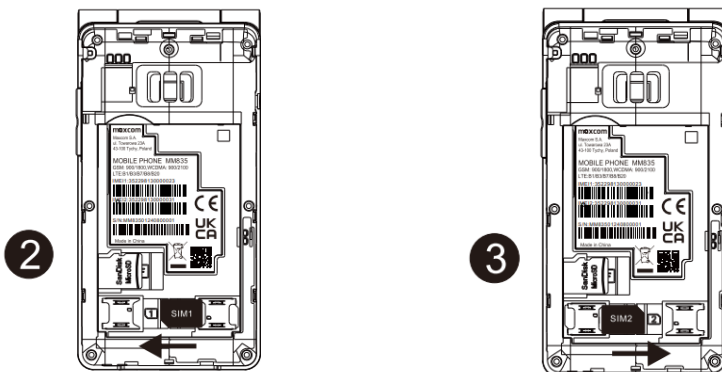

6.3 Memory card installation

Above the SIM1 slot there is a place for Micro SD (TF) memory card. Slowly slide the drawer outside the phone (OPEN) and open it.



Place the memory card in the slot paying attention to the cuts. Close the drawer and slide it inside the phone (LOCK).



Be careful while using memory cards especially while inserting and removing the card. Some memory cards must be formatted on a computer before the first use.

Regularly make backup copies of data stored on cards used in other devices, if you use SD cards. Misuse or other factors might damage the card or make the card lose its content.

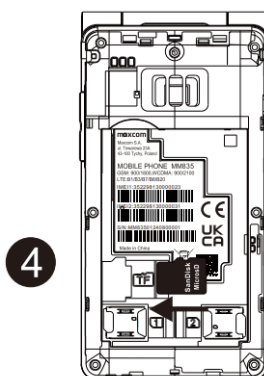

6.4 Battery installation

Insert the battery, make sure the + / - contacts face correctly, and then replace the battery cover.

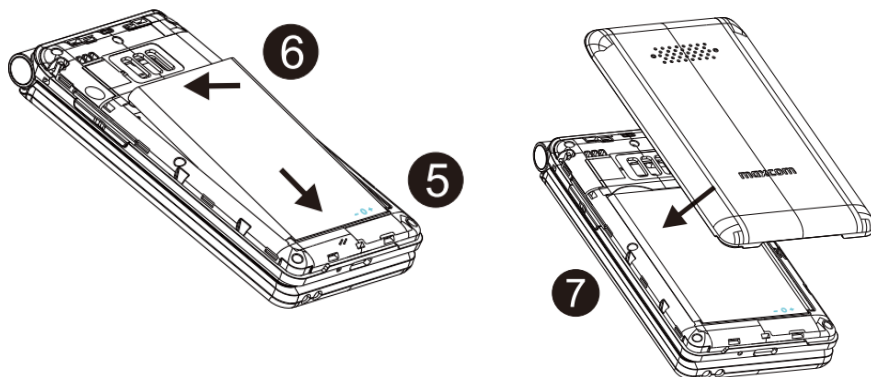

6.5 Connecting the AC adapter and charging battery

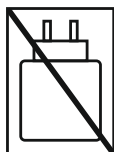

For environmental reasons this package does not include a charger. This device can be powered with most USB power adapters and a cable with USB Type-C plug.

The set includes a USB cable that allows you to charge from a USB port on your computer or connect a charger. Charging speed depends on both the phone and the capabilities of the charger. However, your phone is the determining factor in the maximum power consumption, so it is recommended to use a high-quality charger (e.g. Maxcom ES518-U050200XYE – purchased separately).

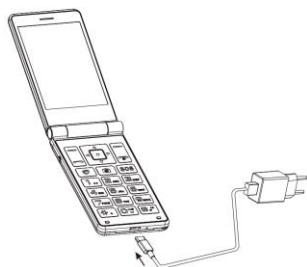

To ensure proper operation of the phone, use a battery recommended by the manufacturer. Using a battery from a third-party source may damage the phone and void the warranty.

Connect the cable plug to the USB Type-C port on the phone and the other USB connector to the power supply. Plug the power adapter into a power socket.

The Maxcom logo and the charging battery icon will appear on the display. This will be a sign that the battery is properly connected and therefore the charging process has started.

When the battery is charged, the message „Charging complete” will appear on the display and the icon showing the battery charge level will stop flashing in the notification bar.

It is recommended to disconnect the charger after the charging process is completed, this will extend the battery life.

If the battery is discharged, the phone will automatically turn off. Do not leave the battery discharged for a long time, otherwise it may adversely affect its quality and service life.

Attention! Power socket must be located near device and easily accessible.

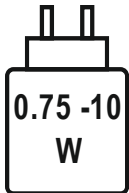

Power deliver by charger must be between a minimum of 0,75W required by radio device and a maximum of 10W to achieve maximum charging speed.

Attention! In order not to damage the battery and the phone, you should: check that the battery is installed correctly before charging and do not remove the battery during the charging process. In case of long-term discharge, after connecting the battery to charge, wait a few minutes before turning on the phone. The battery must not be stored near heat sources. Overheating can cause physical damage to the battery.

6.5.1 Low battery warning

When the battery is low, the phone will alert you to the need to connect to charge with the message „Low battery” and with an acoustic signal (if warning sounds have been enabled in the profile).

6.6 Switching on and off the phone

To turn on the phone, press and hold the red handset key. After a while, the display should light up. After switching on, the display will show a field for entering the PIN code (if SIM card security is enabled). After turning on, the phone automatically searches for the network. If the phone detects an authorized network, the signal strength symbol will appear on the screen. If the network is not found, you can only make emergency calls or use non-communication functions.

To turn off the phone, press and hold the red handset key and then confirm by pressing the OK key.

7 DISPLAY DESCRIPTION

When the phone is turned on but no action is taken, it remains in standby mode.

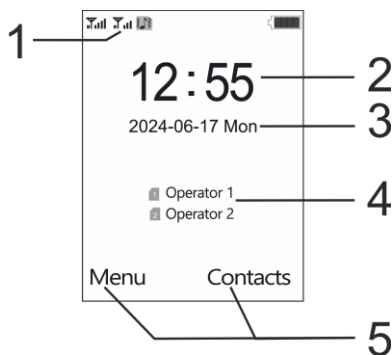

1. Icons showing functions (table below)
2. Time
3. Date
4. Operator name
5. Description of function keys

	Network signal		No SIM card / SIM card error
	No services		Lack of coverage
VoLTE	VoLTE service active	LTE	LTE coverage
3G / G	3G / 2G coverage		Airplane mode
	New SMS / MMS		A missed call
	Vibration only (meeting profile)		Muted (silent profile)
	Alarm active		Roaming active
	Active „Outdoor“ profile		Call forwarding enabled
	Battery full		Battery discharged
Icons may vary depending on software version		* The icon also appears in national roaming when the subscriber uses the network of another operator	

7.1 MENU operation

To enter the MENU, press the left function key in standby mode, according to the description displayed on the display.

To move through the MENU, use the up / down / left / right navigation keys.

To confirm the selected item, press the left function key „OK“.

7.2 Entering text

Press key # to change the input method. Available are:

- Abc – a capital letter after the dot,
- abc – small letters,
- ABC – big letters,
- 123 – numbers.

8 PHONE BOOK

8.1 Saving contacts

There are several options for creating and saving contacts, in standby mode you should:

1. Select the number using the numeric keypad, then press the left soft key Options > Add to contacts. Now you need to choose whether the number is to be saved to a new or existing contact. Then select where to save the contact, in the phone memory or SIM card. After entering the contact name and any other information, press the right function key Save to confirm the creation of the contact.
2. Press the green handset or enter Menu > Call logs > Call logs / Missed / Dialed / Received / Rejected calls, then select one number using the navigation keys and continue as described above.
3. Press the right soft key to enter Contacts > Add contacts, continue as described above.

For contacts that have been saved in the phone's memory, you can set the selected ringtone individually for the contact.

8.2 Browse contacts

To view saved contacts, press the right soft key or Menu > Contacts in standby mode. You can scroll through the contact list using the up / down navigation keys.

8.3 Deleting contacts

8.3.1 Deleting a single contact

To delete a contact from the phone memory or SIM card:

1. Select Contacts,
2. Use the navigation keys to select the contact,
3. Press Options > Delete > OK.

8.3.2 *Deleting several contacts*

To delete several contacts from the phone memory or SIM card:

1. Select Contacts,
2. Press Options > Delete multiple,
3. Use the navigation keys to select a contact and press OK key or Options > Mark,
4. Select all contacts you want to delete,
5. After selecting contacts, you need to confirm their deletion Options > OK > OK.

In case of a mistake, select Options > Unmark and then proceed as described above.

8.3.3 *Deleting all contacts*

To delete all contacts from the phone memory and SIM card:

1. Select Contacts,
2. Press Options > Delete multiple > Options > Mark all > Options > OK > OK.

8.4 Copying contacts

To copy a contact from the phone memory to the SIM card or vice versa:

1. Select Contacts,
2. Press Options > Import/Export > Copy,
3. Press OK key or Options > Select, you need to choose from and to which memory the contacts will be copied,
4. Press Options > OK,
5. Press OK key or Options > Mark selected contacts to be copied,
6. Press Options > OK.

8.5 Speed Dial

On the numeric keypad, after pressing and holding keys 2 ÷ 9, a call will be made to the assigned number in standby mode. To assign a phone number to the appropriate key:

1. Select Contacts,
2. Press Options > Others > Speed dial,
3. Select the key to which the phone number is to be assigned,
4. Press OK key or Options > Edit,
5. Enter a phone number or select a number from Contacts,
6. Press OK to save.

8.6 Memory status

You can save up to 500 contacts in the phone's memory. To check the memory status, select Contacts > Options > Others > Memory status.

8.7 Favourite contacts

The favourite contacts list contains 8 contacts. If a photo has been added to the contact, it will be displayed instead of the default icon. To create a new contact:

1. Press the  key,
2. Select one item and press OK key,
3. Press Options > Enter details or Options > Add from Phonebook if you want to add a contact from the phone book,
4. Complete the contact details,
5. Press the right soft key Save.

9 CALLS

9.1 Dialing calls

9.1.1 *From the numeric keypad*

1. Enter the number you want to call,
2. Press the green handset to make a call,
3. To end the call, press the red receiver.

For international calls, you must enter „+“ or „00“ before the number. The „+“ sign is available by pressing the key * twice.

9.1.2 *From the phone book*

In standby mode, press Contacts using the right soft key or select Contacts in the Menu. Use the up / down navigation keys to select a contact and press the green handset to make a call.

To search for a contact, use the numeric keypad. After selecting Contacts, enter a letter or several letters. Then select the appropriate contact and press the green handset to make the call.

9.1.3 *From the call log*

In standby mode, press the green handset or select Menu > Call logs > Call logs / Missed / Dialed / Received / Rejected calls. Use the up / down navigation keys to select a contact or phone number, then press the green handset to make a call.

9.1.4 *From the favourite contacts*

In standby mode, press the  key. Use the up / down / left / right navigation keys to select the appropriate contact, then press the green handset to make an outgoing call.

9.2 Adjust the call volume

During an ongoing call, you can increase / decrease the call volume using the up / down navigation keys or the + / - keys located on the right side of the phone.

9.3 Options during a call

During an ongoing call, after pressing Menu, a list of functions will be displayed:

1. Connect to BT headset – ability to switch call playback via Bluetooth headset,
2. Add new call – ability to make another call,
3. Hold / Unhold (ongoing call),
4. Mute / Cancel mute,
5. Adjust volume – ability to adjust the volume level of an ongoing call using the up / down navigation keys,
6. Contacts – possibility of entering Contacts,
7. Call logs – ability to check the call log,
8. Messages – possibility of entering Messages.

9.4 Incoming calls

To answer an incoming call, lift the flap or press the green handset or the left soft key.

To mute an incoming call, press the right function key or the + / - key located on the right side of the phone casing.

To reject an incoming call, press the red handset or press the right soft key twice.





10 CALL LOGS

In standby mode, select Menu > Call logs, and then select:

1. Call logs – list of all calls,
2. Missed calls – list of missed calls,
3. Dialed calls – list of outgoing calls,
4. Received calls – list of received calls,
5. Rejected calls – list of rejected calls,
6. Delete all – ability to delete all recorded calls,
7. Call timers – counter storing information about call times,
8. Data service counter – counter storing information about transmitted and received data.

By pressing the green handset, the Call logs will open. This log lists all types of connections, sorting them from the newest, which means that

each next connection will be displayed at the top of the list. The following symbols are used to distinguish the type of call:

-  – dialed outgoing calls,
-  – received incoming calls,
-  – missed incoming calls,
-  – rejected incoming calls.

To move through subsequent items, use the up / down navigation keys. In case of connections of the same type, you can check their number and time of registration.

After selecting one item, pressing Options with the left soft key will display an additional list containing it.

1. Details – connection details,
2. Call – making a call to the selected number,
3. Write message – ability to send SMS or MMS messages,
4. Add to contacts – ability to save the number in the phone book,
5. Add to blacklist – ability to add a number to the blacklist, which will result in blocking calls and text messages for this phone number,
6. Delete – ability to delete register,
7. Delete all – ability to delete all saved registers.

11 SMS AND MMS MESSAGES

The phone allows you to send and receive SMS text messages and multimedia MMS. In standby mode, select Menu > Messages.

11.1 Writing and sending SMS and MMS

There are two ways to enter the SMS sending function:

1. Press the right soft key Contacts,
2. Search for the contact you want to send a message to,
3. Press Options > Write message,
4. Write your message in the text box,
5. Press OK key or Options > Send.

or

1. Press Menu > Messages > Write message,

2. In the upper text field, enter the phone number, contact name, or add a contact from the phone book by pressing OK key or Options > Contacts > select contact > OK key or Options > Mark. If the message is to be sent to several numbers, they must also be marked and then confirmed by selecting Options > OK,
3. Press the down navigation key to move to the text box where you can enter your message,
4. Press OK key or Options > Send.

The list of additional features for SMS can be found in Options > Add, these are:

- Add contact info,
- Add phiz,
- Templates.

When sending MMS messages, proceed in the same way as described above for SMS messages, but you must add a multimedia file. The available features for MMS message are located in Options > Add, they are:

- Subject,
- Picture,
- Take photo,
- Audio,
- Record,
- Video,
- Shoot video,
- Next page,
- Previous slide,
- vCard,
- Other files.

11.2 Reading and replying to SMS and MMS

Received messages are saved in your inbox. To read unread or already read messages, go to Menu > Messages > Inbox. Unread messages are at the top of the list. To read an unread message, select the message and press OK key or Options > View.

After reading the message, press Options and select:







- Reply – sending a return message to the sender,
- Delete – deleting the current message,
- Forward – sending a message to another recipient,
- Call – making a call to the sender,
- Move – changing where messages are stored,

- Add to contacts – saving the sender in the phone book,
- Details – read additional information about the message.

11.3 SMS boxes

11.3.1 Inbox

Stores received SMS and MMS messages, displaying them in order from the newest. In order to distinguish the type of messages and the place of their recording, the following iconography was used:

	Unread SMS message (Saved in phone memory)		Unread SMS message (Saved on SIM card)
	Read SMS message (Saved in phone memory)		Read SMS message (Saved on SIM card)
	Unread MMS message		Read MMS message

Icons may vary depending on software version.

Use the up / down navigation keys to navigate your inbox.

To view additional features, press „Options” while viewing your inbox:

- View – displaying messages,
- Reply – sending an SMS / MMS message to the sender,
- Delete – deleting the current message,
- Delete all – deleting all messages from your inbox,
- Call – making a call to the sender,
- Move – changing where messages are stored,
- Mark – ability to mark selected messages,
- Sort – changing messages sorting categories,
- Add sender to – ability to add a sender to the phone book,
- Delete repeated numbers – select and delete messages from one sender,
- Add to blacklist – ability to add a number to the blacklist, which will result in blocking calls and text messages for this phone number.

11.3.2 Outbox

Stores SMS and MMS messages that failed to send.

11.3.3 Drafts

Stores SMS and MMS messages that have not been sent. To save a message here, create a message and then press Options > Save as draft. The message saved in this way can be edited, deleted or sent to the recipient at a later date.

11.3.4 Sentbox

Stores SMS and MMS messages that have been sent to the recipient. To change the settings for saving sent messages, go to Menu > Messages > Settings >

1. SMS > Save sent messages,
2. MMS > Save sent.

11.4 Deleting messages

To delete a selected message, select „Delete” in Options.

11.5 Message settings

In standby mode, select Menu > Messages > Settings.

11.5.1 SMS

Available options are:

- SMS center – number saved on the SIM card, needed to send SMS messages correctly,
- Validity period – ability to set a time period for reading sent messages by the recipient,
- Status report – ability to enable / disable the message informing about the delivery of the message to the recipient (network service),
- Reply path – ability to enable / disable response path,
- Save sent messages – ability to enable / disable saving sent messages, or ask to save before sending the message,
- Preferred storage – ability to determine where messages are stored,
- Auto signature – ability to enable / disable, the function that adds a signature under each message,
- Signature – ability to edit the signature.

11.5.2 MMS

Available options are:

- Receive options – ability to set MMS downloads in the home network and when roaming,
- Send options – ability to set validity period, priority and delivery report,
- File storage – ability to determine where messages are stored,
- Save sent – ability to enable / disable sound playback of MMS messages,
- Play audio – enabling / disabling sound playback of MMS messages,
- Restore default – restoring default MMS settings.

11.6 Voicemail

Voicemail is an operator's service that allows callers to leave voice recording for the recipient has not answered the incoming call. To connect to your voicemail, simply press and hold key 1. To change your voicemail number, go to Menu > Messages > Voice mail server. You may receive your voicemail number from your service provider. For more information, please contact your operator.

12 MULTIMEDIA

In standby mode enter Menu > Multimedia and then select one of the available functions described below. To increase the number of stored files, install a micro SD memory card. To access additional options and settings, press „Options”.

12.1 Images

Browsing photos allows you to play image files saved in png and jpg formats. To open an image, press OK key or Options > View. Browsing through next images is done using the up / down / left / right navigation keys.

12.2 DV

To start / pause video recording, press the OK key. To end and save the recording, press the left soft key „Stop”. Quick access to „More options” is available under the left / right navigation keys.

12.3 Audio

The audio player allows you to play audio recording files saved in MP3, WAV and AMR formats. To start / pause playback, press OK key. Switching between recording files is done using the left / right navigation

keys. Adjusting the volume level or audio files being played is available by pressing the up / down navigation keys or the side keys + / - .

12.4 Video

The video browser allows you to play video files saved in MP4, AVI, 3GP formats. To play / pause the video, press the OK key. Browse next video recording using the left / right navigation keys. Adjusting the volume level or audio files being played is available by pressing the up / down navigation keys or the side keys + / - .

12.5 Recorder

To start / pause audio recording, press the OK key or Options > Start recording. To end and save the recording, press the right soft key „Stop“.

13 CAMERA

To take a photo, press the OK key. Zoom in / out using the up / down navigation keys. Quick access to „More options“ is available under the left / right navigation keys.

14 FM RADIO

To turn the radio on / off, press the OK key. To search for channels, press Options > Auto search and save. Once you have found the channels, you can select one of them by pressing Options > Channel list > select one channel > OK key or Options > Play. To enable radio playback in the background, press the red handset or Options > Background play. If a headset is connected to the phone, the radio can be played through the speaker, to do so press Options > Open speaker.

Attention! The quality of the received signal depends on where you are. The reception of radio stations is influenced by many external factors that may cause poor reception quality, but this is not a basis for a complaint about the product.

15 TOOLS

In standby mode, enter Menu > Tools and then select one of the available functions described below.

15.1 Calendar

The calendar will remind you about important events or tasks after adding them. Moving between individual dates is done using the up / down / left / right navigation keys. Press the left soft key „Options“ to:

- Add new schedule – adding a task / reminder for a selected day,
- View schedules – displays a list of tasks for the selected day,
- All schedules – displays a list of all tasks,

- Clear today's schedules – deleting sentences for the selected day,
- Clear all – deleting all tasks,
- Go to date – ability to display the selected day,
- Weekly / Daily – switches view.

Attention! The added tasks in the calendar will be called even when the phone is turned off, if the battery status allows it.

15.2 Calculator

The calculator allows you to perform simple mathematical operations. Possible operations are: addition, subtraction, multiplication and division. Using the calculator:

1. Enter the number using the numbers 0 ÷ 9 on the numeric keypad,
2. Select one of the actions using the up / down / left / right navigation keys,
3. Enter the next number,
4. To perform an action, press OK key.

To enter a comma (.), press the * key. To enter a negative number (-), press the # key.

When performing several actions at the same time, they must be done in the correct order (according to art.).

15.3 Alarm

You can set and activate up to 5 alarm clocks. To do this, use the up / down navigation keys to select one item. Then press Options > Edit. When editing, you can change the alarm clock name, time, ringtone and repeat mode. After completing all the data, confirm activation of the alarm clock by pressing Options > Save. To enable / disable the selected alarm clock, press Options > On / Off. When the alarm clock starts, you can turn it off by pressing the left soft key „Off”, or enable the snooze function by pressing the right soft key „Snooze” (the alarm will ring in 5 minutes after selecting this function).

Attention! Enabled alarm clocks will be triggered even when the phone is turned off, if battery status allows it.

15.4 Internet

In standby mode, select Menu > Internet. It is a universal web browser used to browse websites on a mobile device. The Internet function requires installing a SIM card in the phone and enabling data

transmission. For this function to work properly, Menu > Settings > Connections > Network account must contain appropriate settings granted by the operator. To obtain more information in this regard, please contact the operator.

15.5 World clock

This function allows you to check the current time in other parts of the world.

15.6 Bluetooth

Via Bluetooth you can connect other electronic devices, such as a mobile phone or a wireless headset. Bluetooth connectivity allows you to transmit and receive data wirelessly. To turn Bluetooth on / off, select Bluetooth and press the left soft key or OK key. The options for Bluetooth are: Bluetooth visibility, paired devices, device name, storage and help.

15.7 Torch

Ability to turn the flashlight on / off.

15.8 File manager

This function allows you to browse folders and files stored in the phone's memory and the memory card, if one is installed.

15.9 STK (SIM services)

The SIM card may offer additional services independent of the phone itself. The name and functions of this menu depend on the type of services available.

16 SETTINGS

In standby mode, enter Menu > Settings, and then select one of the available functions described below:

16.1 Phone settings

16.1.1 Time & date

The time and date should be edited using the numeric keys 0 ÷ 9. You can change the time format displayed on your phone, the date display type and time update settings. If the phone does not receive data from the GSM network after turning the device back on, or automatic update is turned off, the time and date must be entered manually.

16.1.2 Language settings

When you turn on the phone for the first time, a list of available languages will appear on the display. The phone will select the appropriate language based on the installed SIM card. The user can

also select a different language that will refer to the phone Menu and its functions. In another language was selected by mistake, to restore English, press the Left soft key > Down > Right > OK > OK > Down > OK > Left soft key, then select the appropriate language and confirm your selection by pressing OK.

16.1.3 *Shortcut settings*

In standby mode pressing up / down / left / right navigation keys activates the selected functions. To assign other functions, select the up / down / left / right key and press OK key or Select. Then select one of the available functions and confirm your selection by pressing OK.

16.1.4 *Auto power on/off*

The function allows you to set the phone to turn on and off automatically, which can extend the battery life on a single charge. To enable / disable this function, select the appropriate box and then press Options > On / Off. By pressing the OK key or Options > Edit you can change the time and repeat mode of the action.

16.1.5 *Power management*

The function available here allows to extend the battery life by limiting charging to 80%. When connecting the phone to the charger for the first time, a message will appear on the screen asking the user to enable this function. To confirm its activation, press the left function key OK. Every few dozen charging cycles, it is worth turning off this function to charge the battery to 100%. To turn it off, select Menu > Settings > Phone settings > Power management > Charging up to 80% > Off.

16.1.6 *Restore factory settings*

This option restores the phone to factory settings. After selecting this option, enter the password and confirm by pressing OK. The default security password is: 1234.

16.2 *Call settings*

16.2.1 *Dual-SIM*

SIM card management options such as: standby mode, reply by original SIM and set SIM name. To enable / disable airplane mode, select Standby mode > Flight mode > Turn on / Turn off.

16.2.2 *Answer mode*

The options available here allow to define methods of answering incoming calls, these are: cover answer, any key and auto answer when headset mode.

16.2.3 Call divert

This is a network service for incoming calls and its availability depends on your operator. It is possible to redirect incoming calls directly to voicemail or to a selected number. There are several cases when a call will be redirected:

- Unconditional – absolute redirection of all incoming calls,
- When busy – redirection of an incoming call if another call is already in progress,
- When unanswered – redirecting an incoming call if it is not answered,
- When unreachable – redirecting an incoming call if the phone is out of network coverage,
- Cancel all diverts – canceling all enabled redirects.

To enable the selected redirection, press OK key or Select > On, then select whether the redirection should take place to voicemail or to a telephone number. After completing the data, confirm by pressing OK.

To disable the selected diversion, press OK key or Select > Off.

To check the status of the selected diversion, press OK key or Select > Check status.

16.2.4 Call waiting

This is a network service for incoming calls and its availability depends on your operator. If during a call there is an incoming call and the call waiting function has been enabled, you can put the current call on hold or hang up and answer the incoming call by selecting one of the options in the Menu by pressing the left soft key.

Enabling, disabling and checking the status of this function is the same as for call forwarding.

16.2.5 Call barred

This is a network service for incoming calls and its availability depends on your operator. This function allows you to block: all outgoing and incoming calls, incoming calls when roaming, international call and cancel all barring.

Enabling, disabling and checking the status of these functions is the same as for call forwarding.

16.2.6 Caller ID

This is a network service for outgoing calls and its availability depends on your operator. This function allows you to make a choice

for presenting your number to the recipient of the call. The available options are: Hide ID, Display own ID and Display ID by network.

16.2.7 Others

Additional calling options included in the phone are:

- Call time minute reminder,
- Auto redial,
- Vibration when connected,
- Reply SMS after reject.

16.3 Display

In this part the settings can be customized:

- Wallpaper,
- Screen saver settings,
- Contrast,
- Backlight,
- Keypad backlight time,
- Font size.

16.4 Theme

This function allows you to change the way all content is presented on your phone. There are two types of topics to choose from.

16.5 Profiles

The phone contains 7 types of profiles and the ability to add new ones that are responsible for its behavior in various situations. Profiles can be activated and personalized according to your need. The available profiles are: Normal, Silent, Meeting, Indoor, Outdoor, Earphone and Bluetooth. To activate the selected profile, press the OK key. To personalize the selected profile, press Options > Settings, then make changes to:

- Rename – changing the profile name,
- Ring settings – ability to set separate ringtones for incoming calls and text messages,
- Adjust volume – ability to adjust the volume level for individual functions,
- Ring type – ability to set separate ringtone types for incoming calls and SMS,
- Other alert rings – ability to change the key tone, battery low alert, power ringtone, dial tone and open and close flip tone.

In standby mode, by pressing and holding the # key you can quickly activate the Normal, Silent and Meeting profiles.

16.6 Dial Num Voice

This function allows you to speak numbers while dialing and during incoming calls. To enable / disable individual functions, simply select the appropriate option and press the OK key or the left function key.

16.7 Side key +/-

Possibility to enable or disable the side keys +/-.

16.8 Menu selection

These settings allow to adjust the visibility of phone functions in the Menu. To hide selected functions, enter Own choice, then select the appropriate function and press the OK key or the left soft key Off. After selecting the remaining functions, press the right soft key Save to save the settings. To restore the visibility of hidden functions, repeat the process by selecting a given function, then select it and press Save. It is also possible to select Menu 1 or Menu 2, which already have defined visible functions in the Menu.

16.9 Security

16.9.1 PIN

The PIN code is the identification of your SIM card and is provided by your operator. When turning on the phone, you must enter the PIN code if the SIM card has such protection enabled. To enable / disable the PIN code, enter the PIN. You can change your PIN by selecting Modify PIN. Entering an incorrect PIN code 3 times in a row will block the SIM card. It can be unlocked using the PUK code. Entering the PUK code incorrectly 10 times will block the SIM card permanently. To obtain information about the PIN or PUK code, please contact the operator.

16.9.2 Modify PIN2

The PIN2 code of the SIM card also depends on the operator, so you must contact your operator to obtain it.

16.9.3 Phone locked

When turning on your phone, you will need to enter your password if this feature is enabled. The default password is: 1234.

16.9.4 Modify the cellphone password

Possibility to change the password for the phone lock.

16.9.5 Privacy

The privacy protection feature protects selected features of your phone. A security code is a password to lock the phone.

16.9.6 Fixed dialing number

This is a network service for outgoing calls and its availability depends on your operator. To enable it, a PIN2 code is required. For more information, please contact your operator.

16.9.7 Blacklist

This function blocks calls and messages from numbers that have been added to blacklist. To add a phone number, select Blacklist > Options > New or Import contacts. In the blacklist settings you can enable / disable call and message blocking.

16.10 Connections

In this section the settings can be customized:

- Network account – you can get the correct configuration from your operator; some operators allow you to configure your phone remotely,
- Data service – enable / disable GPRS connection, required for some network functions,
- Data roaming – ability to choose whether the data connection is to be established while roaming,
- Preferred data SIM – if two SIM cards installed in the phone, you can choose which SIM card to download mobile data from,
- Network selection – ability to select the network automatically or manually,
- Network type – ability to select your preferred connection with 4G/3G/2G network type,
- VoLTE – ability to enable / disable making calls via LTE.

Individual network settings may vary for individual operators and SIM cards. For more information, please contact your operator.

16.11 Check update

This function provides the ability to install software updates if they become available in the future.

17 SOS

This function allows you to provide personal and medical data as well as emergency contacts. They can be helpful to paramedics in an emergency situation.

The abbreviation ICE (In Case of Emergency) is known by paramedics all over the world and allows you to obtain important information about the injured person, therefore it is recommended to complete

the emergency contacts (ICE contacts) and information about the user (owner of the device). Adding this data is described below.

17.1 ICE contacts

To add a contact, select the selected item and press OK key or Options > Edit, and then enter the phone number, or add a number from the phone book by selecting Import contacts. After adding the phone number, press OK to confirm your selected contacts. To edit / delete a saved contact, simply select Edit / Clear for the individual contact.

Attention! Selected emergency contacts should have their voicemail turned off, as recording a voicemail message to voicemail is treated as a received calls.

17.2 Owner info

To add information, select Name, Disease, Allergy and Blood group, then press OK. After entering the data, confirm the data by pressing Save. In order to edit them, you must repeat the proces as for adding data.

17.3 SOS button

The SOS button is located on the phone's keyboard. To enable / disable its activity, go to SOS > SOS Status. Press and hold the SOS button to activate the SOS procedure. The phone will make calls to the numbers provided in the ICE contacts section. If ICE contacts have not been added, the call will be made to the emergency number 112. If SOS was activated accidentally, press the red handset or „Exit” using the right function key.

17.4 SOS SMS

After activating the SOS procedure, the phone will make a call as described in point 17.3, but will also send an SOS SMS message. The default message content is: „Please help me! I am in an emergency”. This function can be turned on / off in SOS > Send SOS SMS. The content of the message is fixed, and to change it, go to SOS > SOS message settings.

17.5 Emergency alarm

When the alarm function is activated, the phone will also inform you about it with a sound. To turn on / off the sound alarm, go to SOS > Emergency alarm.

18 CONNECTION TO A COMPUTER

You can connect your phone to your computer using a USB cable, so you can copy and move files between your phone and computer. To connect your phone.

1. Insert the cable into the USB-C port on your phone,
2. Connect the other end of the cable to the USB port on your computer,
3. The phone screen will display the following messages: „Charging“, „USB storage“ and „PC connecting“. Select storage devices.

19 FAQ (TROUBLESHOOTING)

Only qualified service workers are authorized to repair the phone. Any attempts of unauthorized repair and modifications void the warranty!

„Can not make a phone call“	Make sure the number you are dialing is correct. If you make an international phone call, dial a country code before the actual number (e.g. 0049 or + 49 for Germany). If you have a prepaid card, make sure there are sufficient funds available on the card to place a phone call.
„SIM card in place, emergency calls only (112)“	Make sure the SIM card is installed correctly.
„The phone does not work, the phone does not charge when plugged in“	If you have not used the phone for a long time, the battery might be „deeply-discharged“, to recover a deeply-discharged battery leave your charger plugged in, although there will be no image on the display.
„Can I make a phone call while abroad?“	If you are out of the country and ROAMING is enabled, your phone automatically will use the foreign telephone network. To learn more, contact your service provider.
„Can I make an emergency call if there is no reception or if there are no funds on my account?“	If you are in the area with no reception by any network, no phone calls can be made. If you have no funds available on the account, emergency call to 112 can be made.

„How to get the most of reception?”	If there is a message „Does not work” on the display, it means there is no signal or sufficient funds on the account. In such a case, only making emergency call 112 is possible as long as the User is in the area covered by another service provider. Reception might be weaker if you are inside buildings. Move towards windows or get outside.
„What is the Text Message Center?”	It is the service provider’s center number storing all text messages. The number is stored on the SIM card, but you can change the number in the phone MENU and enter another number.
„When is the fee for making a phone calls charged?”	A fee for making a phone call is charged as soon as a phone call is made. To learn more about charging details, contact your service provider.
„Is there any way to make sure my message was delivered to the recipient?”	Enable Delivery Report option. As soon as the text message is delivered to the recipient, you will get a return message (network service).

20 TECHNICAL SPECIFICATIONS

20.1 Main functions:

Color display: 3.5" IPS HVGA 240x320 and 2.4" TN QVGA 240x320

Large backlit keys

SOS button (Emits an alarm and automatically calls and sends SMS to previously defined numbers)

Hands-free function

Phone book: 500 entries

Function of sending and receiving SMS and MMS

Speed dial numbers (2 ÷ 9)

Camera / camera 0.3 MP

FM radio

Audio file played (MP3 / WAV / AMR)

Video player (MP4 / AVI / 3GP)

Dictaphone

Calendar, calculator, flashlight, alarm clock

RAM + ROM: 48 MB+128 MB

MicroSD memory card reader: max. 128 GB

Dual SIM: Nano SIM + Nano SIM

Battery capacity: 1400 mAh

Weight of the handset with battery: 132 g

Dimensions: 113.8x57x17.7 mm

20.2 Operating Frequency Range and Max Conducted Power

System	Frequency Range	Maximum emitted power
GSM 900	Uplink 880 MHz ~ 915 MHz; Downlink 925 MHz ~ 960 MHz	32.94 dBm
GSM 1800	Uplink 1710 MHz ~ 1785 MHz; Downlink 1805 MHz ~ 1880 MHz	31.12 dBm
WCDMA Band I	Uplink 1920 MHz ~ 1980 MHz; Downlink 2110 MHz ~ 2170 MHz	22.60 dBm
WCDMA Band VIII	Uplink 880 MHz ~ 915 MHz; Downlink 925 MHz ~ 960 MHz	23.21 dBm
LTE Band 1	Uplink 1920 MHz ~ 1980 MHz; Downlink 2110 MHz ~ 2170 MHz	23.49 dBm
LTE Band 3	Uplink 1710 MHz ~ 1785 MHz; Downlink 1805 MHz ~ 1880 MHz	22.66 dBm
LTE Band 7	Uplink 2500 MHz ~ 2570 MHz; Downlink 2620 MHz ~ 2690 MHz	24.84 dBm
LTE Band 8	Uplink 880 MHz ~ 915 MHz; Downlink 925 MHz ~ 960 MHz	23.80 dBm
LTE Band 20	Uplink 832 MHz ~ 862 MHz; Downlink 791 MHz ~ 821 MHz	23.48 dBm
BT short range communication (EDR)	2402 MHz ~ 2480 MHz	5.38 dBm
FM radio	87.5 MHz ~ 108 MHz	-

20.3 SAR information

Information about the impact of radio waves and Specific Absorption Rate [SAR]. This phone model has been designed to meet all international standards pertaining to the impact of radio waves as recommended by international guidelines. These guidelines were developed by the International Commission on Non-ionizing Radiation Protection (ICNIRP), an independent scientific organization with a safety margin to protect all people regardless their age and health condition. Such guidelines use a unit of measurement called Specific Absorption Rate (SAR) – actual absorption. As recommended by ICNIRP, the border value of SAR for portable equipment is 2,0 watts per kilogram (W/kg), and it is an average value per 10kg of tissue. SAR value is determined at the maximum transmit power and in the full spectrum of frequencies covered by research; the actual SAR value while the product is working might be much lower than the maximum level. Such discrepancies result from automatic changes in device power necessary to ensure that the device operates at a minimum power level required to be connected with network.

This device was tested for typical body-worn operations. To comply with RF exposure requirements, a minimum separation distance of 5 mm must be maintained between the user's body and the handset, including the antenna. Third-party belt-clips, holsters, and similar accessories used by this device should not contain any metallic components. Body-worn accessories that do not meet these requirements may not comply with RF exposure requirements and should be avoided. Use only the supplied or an approved antenna.

Highest measured SAR value in tests		Limit
SAR rate – device on the head	0.923 W/kg 10g	2.0 W/kg
SAR rate – device at the torso (distance 5 mm)	1.375 W/kg 10g	2.0 W/kg
SAR rate – device at the limb (distance 0 mm)	2.357 W/kg 10g	4.0 W/kg

21 BATTERY INFORMATION

There is a battery in the phone that is supposed to provide emergency power in case of power blackout. This battery is charged with the AC Adapter, included in the set.

The telephone life powered by the battery depends exclusively on conditions under each the phone is used. Your distance from a relay transmitter, number and the length of phone calls significantly reduce its life.

After multiple charges and discharges, it is natural for the battery to eventually lose its ability to hold charge. Get a new battery as soon as you notice a significant drop in the battery performance.

Use only batteries recommended by the Manufacturer.

Never keep the phone in places with too high temperature; doing so might negatively impact the battery and the phone.

Never use the battery that is clearly damaged; doing so might damage the phone. The battery must be positioned according to its polarization.

Leaving the battery in places with too high or too low temperature will reduce its life. The battery should be kept in the temperature between 15°C and 25°C.

22 PROTECT YOUR ENVIRONMENT



Old batteries pose environmental risks. They should be disposed of at a special place in a special container in compliance with current regulations. Never throw old batteries or chargers to municipal solid waste, they should be collected for disposal.

NEVER PUT BATTERIES AND CHARGERS INTO FIRE!

Important! The phone is marked in compliance with the European Waste Electrical and Electronic Equipment Directive of 2012/19/UE (WEEE) and the Polish Act on Waste Electrical and Electronic Equipment, and with the symbol of waste electricals.



Such a symbol tells us that the device, after use, must not be disposed of in the normal household waste stream.

Important! Never throw the phone nor accessories to municipal solid waste!!! The product should be utilized in authorized places only.

As the product contains hazardous components, improper storage and use of such equipment might lead to serious consequences harmful for both people and natural environment.

To facilitate recycling of materials used to produce the phone package, follow the local rules pertaining to material sorting for this kind of waste.

23 SIMPLIFIED EU DECLARATION OF CONFORMITY

Maxcom S.A. hereby declares that the radio equipment type MAXCOM MM835 mobile phone is compatible with:

Directive 2011/65/UE of 8 June 2011 (RoHS restriction of the use of certain hazardous substances in electrical and electronic equipment);

Directive 2014/53/UE RED of 16 April 2014 (Radio Equipment Directive).

The full text of the EU Declaration of Conformity is available at the following internet address: <http://www.maxcom.pl/deklaracje>

24 UK DECLARATION OF CONFORMITY

Hereby, Maxcom S.A. declares that the radio equipment type

Desktop Mobile phone MAXCOM MM835 is in compliance with the relevant UK legislation.

The full text of the UK declaration of conformity is available at the following internet address: www.maxcom.pl/deklaracje

This Manual is provided for information purposes only. Some functions and options might vary depending on software and the country.

The Manufacturer shall not be liable for any consequences arisen from misuse, abuse or any other use of the phone in violation of this User Manual.

Important! The Manufacturer reserves their right to modify a product and its features without prior notifications. Any trademark mentioned or used in this material remain the sole property of their owners.

**MAXCOM S.A.
43-100 Tychy,
ul Towarowa 23a
POLAND
tel. 32 327 70 89
fax 32 327 78 60**

**www.maxcom.pl
office@maxcom.pl**

